



Stourton View, Frome

Stourton View, Frome, BA11 1QH

This stand-alone 4 bed property sits quietly off the ever-popular Whitewell Road. A Bespoke green oak timber porch frames the entrance welcoming you into this spacious family home. Through the front door, immediately off the hallway you will find a downstairs WC, study and cloak room leading to the generous sized garage. To the left of the hall is the perfect snug complete with marble fireplace surrounding a gas fire, two fitted bookshelves and bespoke fitted Venetian blinds. The kitchen is fitted with modern base and wall units that is broken up by a splash of colour in the form of showstopping orange Smeg Range cooker. Floating Iroko wood shelves and a very generous pantry provide all the necessary storage for a family kitchen. Integrated fridge, freezer and washing machine are all hidden from sight behind the sleek design of the kitchen. The dining room is a spacious entertaining space, leading through an arched doorway you are led into the sun-drenched living room. Both the dining room and living room benefit from direct access to the garden, and an unusual double facing wood burner, creating welcoming environment during any season. Upstairs the property boasts three double bedrooms with the continuation of bespoke venetian blinds. The primary bedroom sits at the front of the house with a large ensuite shower room. A smart dressing room is currently occupying the fourth bedroom, a large freestanding wardrobe with floor to ceiling mirrored doors add a level of luxury to the use of the room. To the rear of the property there is a southwest walled garden, mainly laid to patio creating a real suntrap, a perfect entertaining space. Following round to the right is another secluded patio. The borders are mature and well stocked and maintained, there is a large woodstore, garden shed, and greenhouse. Council Tax Band – D, EPC – D, Services – Mains electricity, Mains gas, Mains water, Mains drainage.







Score	Energy rating	Current	Potential
92+	A		
81-91	B		
69-80	C		80 c
55-68	D	68 d	
39-54	E		
21-38	F		
1-20	G		



3HighStreet,Corsham,WiltshireSN13 0ES
Email:corsham@hunterfrench.co.uk

19PaulStreet,Frome,Somerset,BA111DT
Email:frome@hunterfrench.co.uk

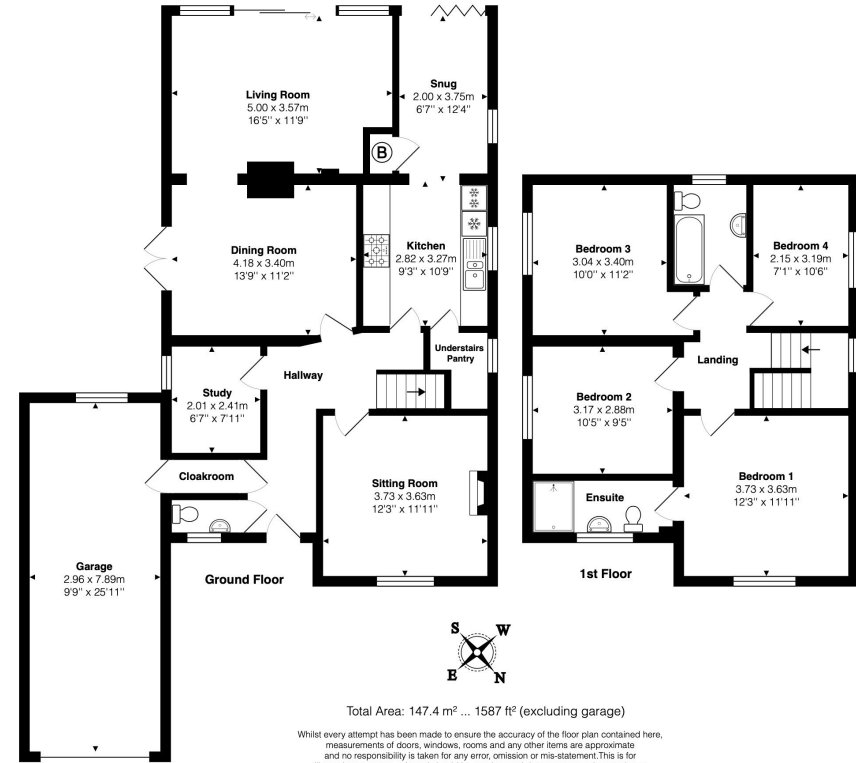

FromeOffice:01373464040 | CorshamOffice:01249715775 | AssociatedParkLane:0203688974
BathOffice:01225444454 | DevizesOffice:01380722784 | TetburyOffice:01666505068

*Bath, Devizes & Tetbury are all Non Guild Member Offices

www.hunterfrench.co.uk